

SEE MAP 26-5

SEE MAP 26-5

SEE FAYETTE COUNTY

SEE MAP 26-5

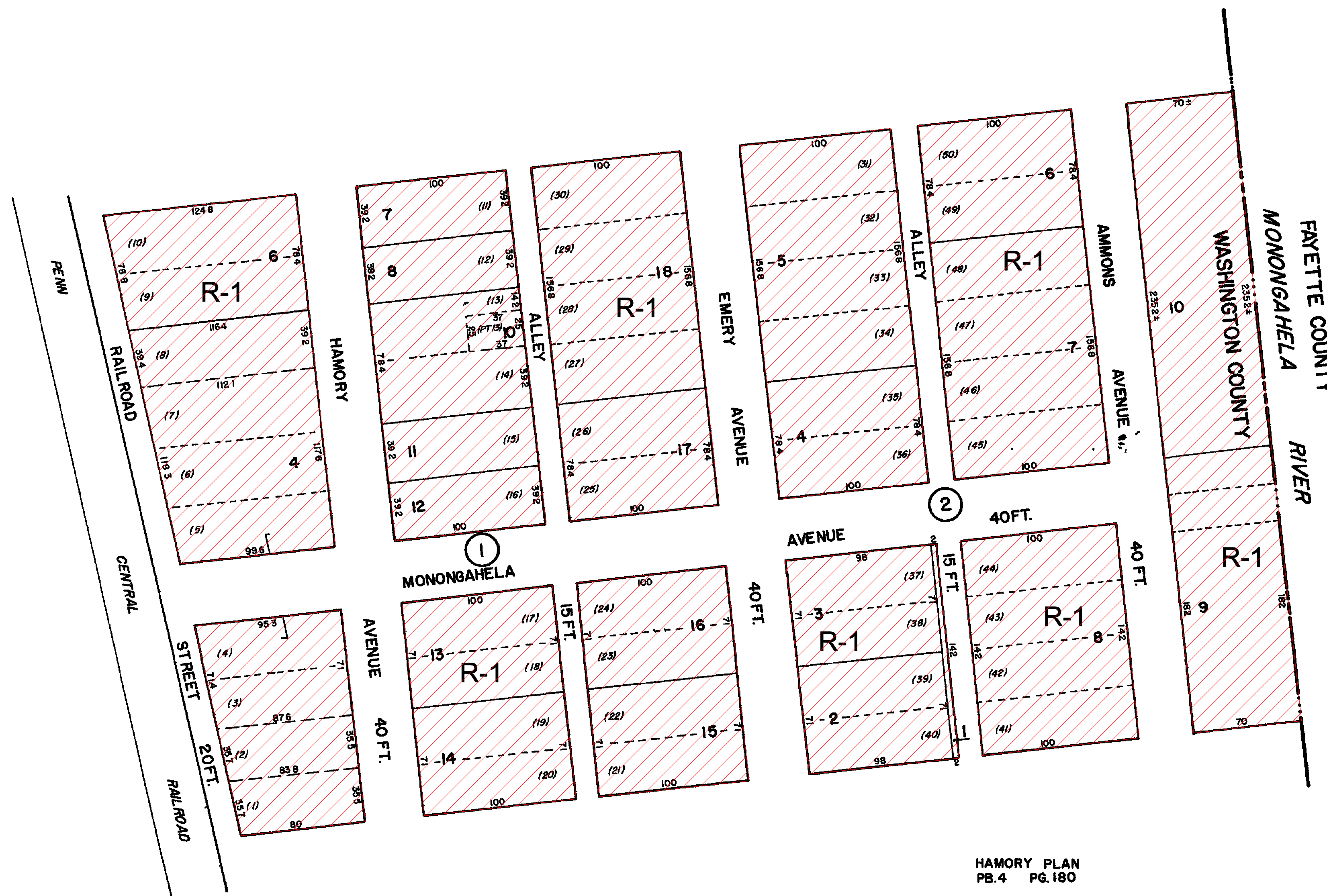

HAMORY PLAN
PB. 4 PG. 180



NOTICE

This map has been prepared, as required by law, for Tax Assessment purposes ONLY. It has been compiled from records in the office of the Recorder of Deeds, the office of the Board of Assessment and Revision of Taxes, the office of collaborating engineers, and, in some cases, from information gathered by field work.

The Washington County Board of Assessment and Revision of Taxes

CLT
BALANCED
GOVERNMENTAL
SERVICES
Tax Mapping Division
COLE LAYER TRUMBUE CO
3325 Siltan Avenue Dayton, Ohio 45406

LEGEND

STATE-COUNTY LINE	-----	ORIGINAL LOT LINE & NO	----- (20)
BORO-TOWNSHIP LINE	-----	LAND HOOK & ROAD R/W	-----
WARD LINE	-----	RAILROAD R/W	-----
PROPERTY LINE	-----	WATER	-----
DIMENSIONS (Deed) (Scoted) 112' 6" 112'		BLOCK NO	④
AREA (Deed) (Calculated) 117Ac 117Ac±		PARCEL NO	27
CHURCH	⊕	SCHOOL	⊕
CEMETERY	†		

REAL PROPERTY MAP
EAST BETHLEHEM TOWNSHIP
WASHINGTON COUNTY
PENNSYLVANIA

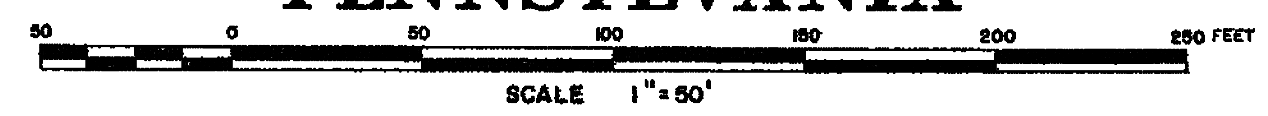

REVISIONS	BY	DATE
1		
2		
3		
4		
5		

COMPILED: 9-19-72 PHOTO: 12-279

MAP NO.
26-15